

braintronics®

Body&Mind syncSystem

CASADATM
healthcare



< timeto relax



SKYLINER II



< timetorelax

Since the company was founded back in the year 2000, the name CASADA has become synonymous with high-quality products in the wellness and fitness sector.

Today, CASADA products are available worldwide. Continuous development, unmistakable design and a strict focus on improving quality of life are just as much characteristic of CASADA products as reliable and top-class quality.

Congratulations

By purchasing this massage chair, you have demonstrated an awareness for your health.

So that you can benefit from the advantages of this massage chair for a long time, we would ask that you read and observe the safety instructions carefully.

We hope you really enjoy using your personal Skyliner II.

Table of Contents

Safety Instructions	20
Contraindications.....	21
Warnings on Use.....	22
Features Functions.....	23
Set-up and Assembly.....	24
Cleaning Maintenance Storage	31
Troubleshooting	32
Specifications.....	32
EU–Declaration of Conformity	33
Warranty Conditions.....	33

Safety Instructions



Please read the following instructions carefully before using your massage chair to ensure that it functions properly and with optimal efficiency. Please keep these operating instructions for further use!

- The massage chair conforms to recognised technical principles and the latest safety regulations.
- The massage chair is equipped with heated sections. Persons who are sensitive to heat should take care when using the product. (ICE 60335-2-32)
- The massage chair does not require maintenance. Any potential repairs may only be carried out by authorised experts.
- Improper use and unauthorised repairs are not permitted for safety reasons and lead to loss of warranty.
- In order to avoid injury, please do not stick your fingers between the massage rollers.
- Never touch the mains plug with wet hands.
- Do not allow the massage chair to come into contact with water, high temperatures and direct sunlight.
- Do not use the massage chair in an environment with high humidity levels e.g. in the bathroom.
- Do not use the massage chair in an area with insufficient space or in an area where ventilation is covered and a supply of fresh air is not guaranteed.
- To avoid the danger of short-circuits, disconnect the massage chair from the power supply if it is not in use for a long period of time.
- Do not use any damaged plugs, cables or loose sockets.
- If cables/plugs are damaged, they must be replaced by the manufacturer, a service representative or by qualified personnel.
- In the case of malfunction, immediately disconnect the product from the mains.
- The company disclaims any liability for damage if the product is used inappropriately or incorrectly.
- Do not exceed the daily recommended massage duration of 30 minutes in order to avoid excessive strain on the muscles and the nerves.
- To avoid damaging the massage chair, never use pointed or sharp objects.
- In order to reduce the danger of short circuits or fire, it is essential to use only sockets that fit the plug. Ensure that the plug is fully inserted into the socket.
- Disconnect the massage chair from the power supply after use and before cleaning.
- Do not allow children under 14 to clean or maintain the product without supervision.
- If an unexpected power failure occurs during use, immediately set the switch to the OFF position and disconnect the plug in order to avoid damage to the massage chair.
- Do not use the massage chair if the electric cables are wet or damaged.
- Children under the age of 14 and/or disabled or frail people who are in the vicinity of the massage chair or using the massage chair must be supervised by all means.
- Do not use the massage chair immediately after consuming a meal or when under the influence of alcohol.
- Only use the product for the purpose described in the operating instructions.
- Please only use accessories provided by the supplier.
- To prevent damage, please do not stand, sit or bounce on the footrest.
- To avoid damage or injury, do not try to sit on the armrests or backrest.
- Please clean your massage chair regularly and prevent foreign bodies from penetrating the crevices of the massage chair.
- Please do not pull directly on the mains cable.
- When adjusting the position of the footrest or the backrest, please ensure that there are no other objects underneath, in particular no children under the age of 14.
- The product is only intended for domestic use.
- If the flexible power cable becomes damaged, another flexible cable designated for the same purpose must be used or a suitable replacement cable must be purchased from the manufacturer or their service point.

Contraindications

If you are unsure whether you should use the massage chair, consult your doctor by all means.

- Use of the massage chair is prohibited during pregnancy or in the case of one or several of the following complaints: Recent injuries, thrombotic diseases, any kinds of inflammations and swellings, and cancer. If you are undergoing treatment for illnesses or conditions, it is recommended that you consult a doctor before getting a massage.
- Persons with physical, cognitive or mental impairments, or persons lacking experience and knowledge should only use this massage chair under the supervision and guidance of persons responsible for their safety.
- In order to avoid any discomfort or danger when using the massage chair, we would ask the following people to consult a doctor before using the product:
 - Non-ambulant persons
 - Persons receiving medical treatment
 - Persons suffering from back pain and persons with spinal problems, and persons with spinal problems or curvature of the spine
 - Persons with pacemakers
- If you experience pain during the massage, stop the treatment immediately.
- If you injure yourself whilst using the chair, seek immediate medical treatment.
- Please do not massage any reddened, swollen or inflamed areas of the skin.
- This massage chair is intended to be used only for home wellness massages and is not a medical massage device. It can therefore not be used as a substitute for specialist medical treatment.
- We recommended that you use the massage chair for 30 minutes on a daily basis. Individual areas of the body should be massaged for a maximum of 15 minutes at a time, as excessive massaging can otherwise be counter-productive.
- This product is not suitable for children under the age of 14.
- Children under the age of 14 must be supervised. Ensure that children do not play with the massage chair.

“BRAINTRONICS” CONTRAINDICATIONS

- Psychoses (e.g. Schizophrenia, bipolar disorder, endogenous depression)
- Personality disorders
- Epilepsy and similar seizure disorders
- Heart conditions
- Diseases of the central nervous system
- Thrombosis
- Endogenous depression
- ADHD (under-active)
- Recent heart attack or stroke
- Mental disability
- Addictions such as to drugs or alcohol or prescription medicines
- Regular intake of psychotropic drugs
- Pregnancy

NOTE: For ethical and legal reasons, braintronics should not be used on children and young people without the explicit permission of the legal representatives. Persons for whom meditation may conflict with religious beliefs should refrain from using the product.

Warnings on Use

NOTE

For your own safety and to avoid damaging the massage chair, do not exert pressure on the footrest when extended.

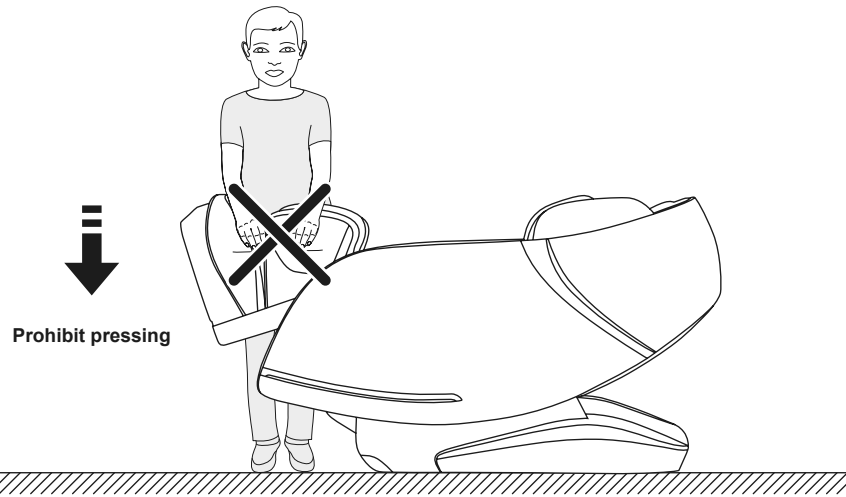

NOTE

Before each massage, make sure that the massage rollers are not in the seat area.

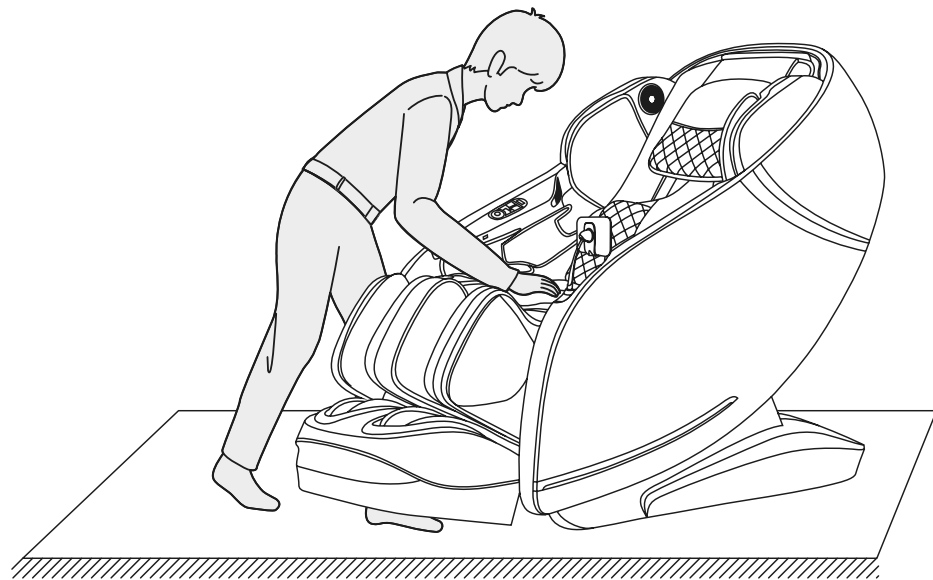

Features | Functions

1. Pillow
2. 3D digital speakers
3. Shoulder airbag
4. Backrest cushion
5. Lumbar airbag
6. Ion air blower
7. Quick launch buttons
8. USB charging connector
9. Arm airbag
10. Storage space
11. Seat cushion
12. Calf massage
13. Armrest
14. LED lamps
15. Foot massage

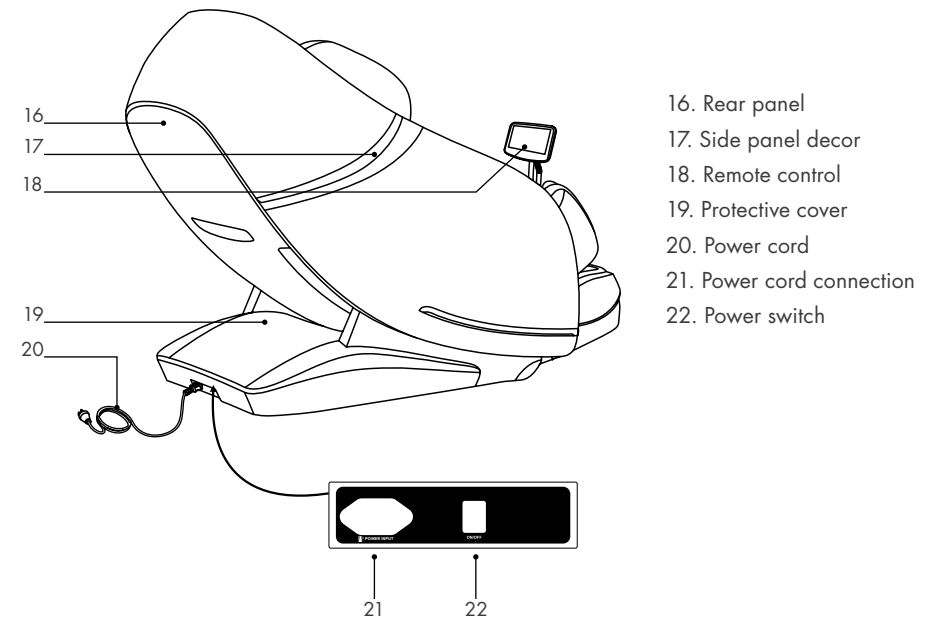
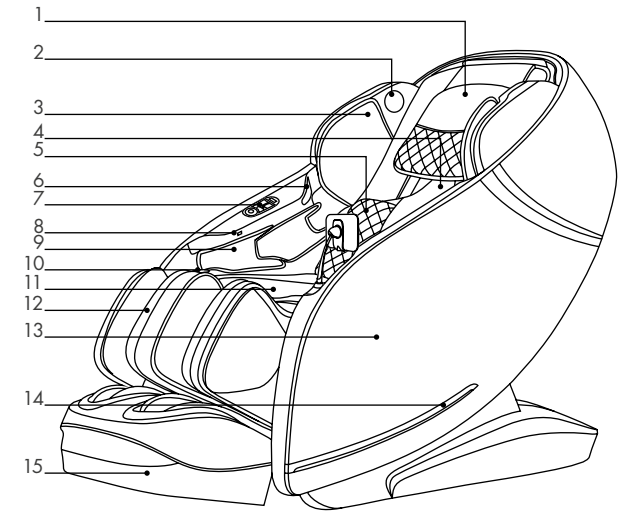

Set-up and Assembly

1. Assembling the armrest

- From the arm rest, first remove the connectors and the air hose which match those on the frame of the massage chair (Fig. 1).
- Now link each connection with its counterpart (colour-coded). (Fig. 2).

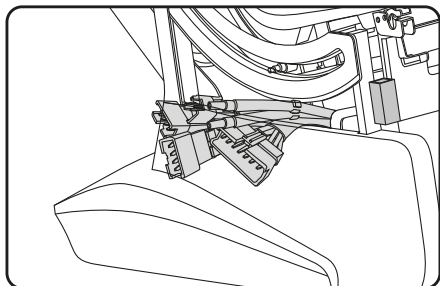

Fig. 1

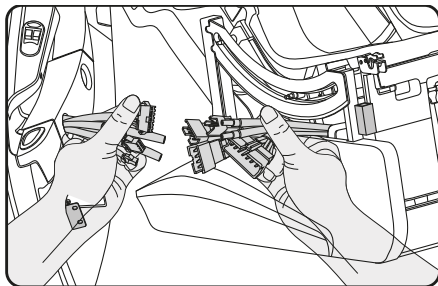

Fig. 2

- Insert the connecting parts on the underside of the frame firmly into the armrest connection. Correctly position the compressed air line. (Fig. 3).
- After connecting with the appropriate connection lines, carefully insert the middle of the steel pipe behind the steel frame manually into the lower part of the frame, making sure that the compressed air line is not blocked or damaged. (Fig. 4).

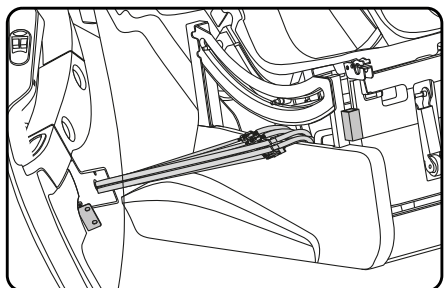

Fig. 3

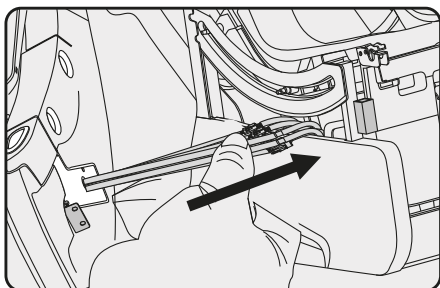

Fig. 4

- Now hang the bolt on the rear side panel (inner side) into the guide on the massage chair. (Fig. 5)
- Lock the front attachment of the seat in position and use slight pressure to hook this into place. (Fig. 6)

Set-up and Assembly

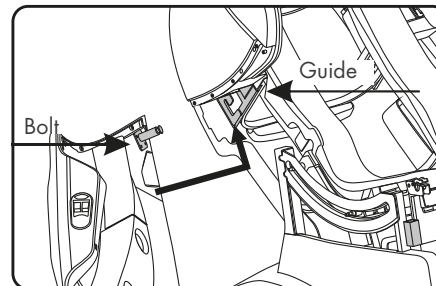

Fig. 5

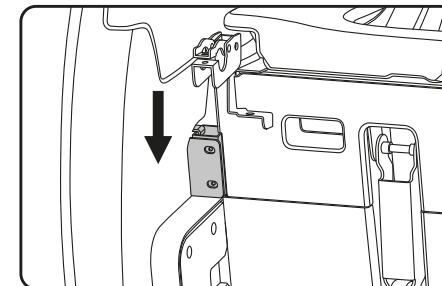

Fig. 6

- Use 2x (M5X10) screws to secure the front attachment. (Fig. 7).
- Use 5x (M4x10) screws to secure the rear side of the side panel. (Fig. 8).

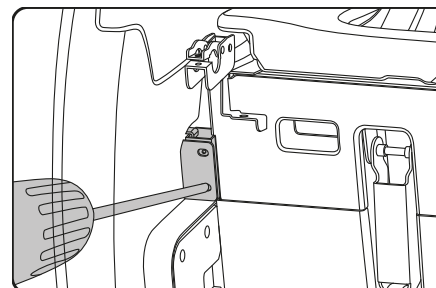

Fig. 7

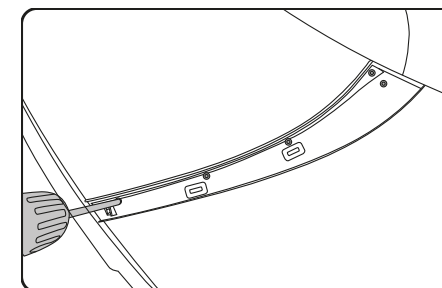

Fig. 8

- Narrow side first, hook the covers into the side panel and then clip the mask onto the side panel. (Fig. 9).
- From the inner side of the shoulder part, use one ST4,2x16 screw to secure the cover. When assembling, the assembly instructions for the two side panels are identical. (Fig. 10)

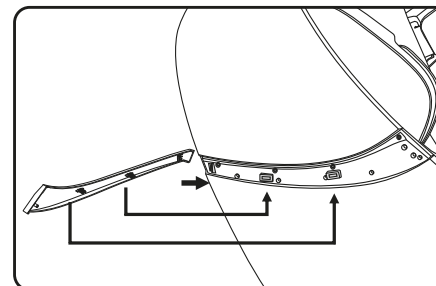

Fig. 9

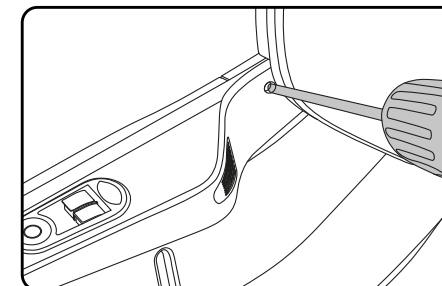

Fig. 10

Set-up and Assembly

2. Assembling the footrest

- Position the foot rest in front of the seat and connect the air hose and plug to the counterpart on the seat (Figs. 1 + 2).
- Then push any protruding air hose and cable back into the seat.

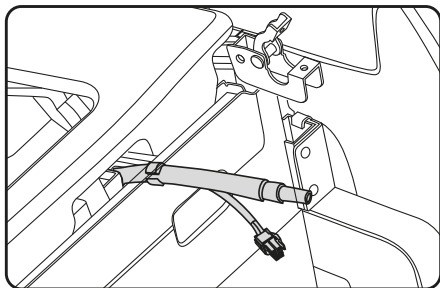

Fig. 1

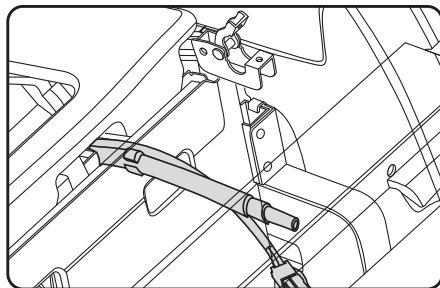

Fig. 2

- Slide the inner and outer sleeves onto the mounting bracket on the footrest. Check that the head end is facing the footrest (Fig. 3).
- On the inner side of the seat, open the hinges on the right and left (Fig. 4).

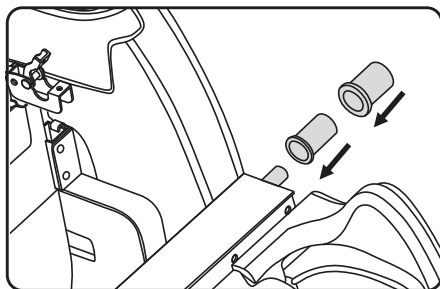

Fig. 3

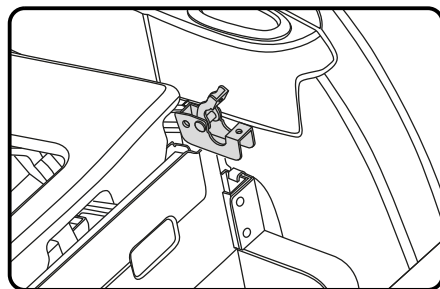

Fig. 4

- Hang the footrest with the sleeves into the hinges (Fig. 5)
- Close the hinges and secure them using an M5 screw. (Fig. 6)

Set-up and Assembly

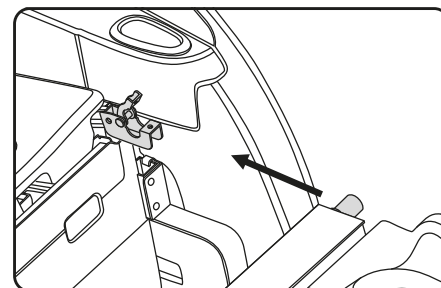

Fig. 5

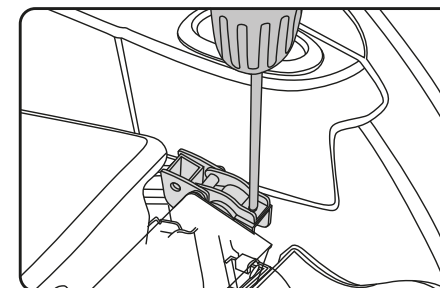

Fig. 6

- Then place the plastic covers over the hinges. (Fig. 7)

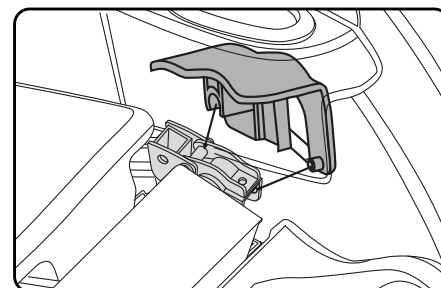

Fig. 7

3. Assembling the touchscreen bracket

- Insert the holder into the side panel and secure it using 3x M4 screws. (Figs.1+2).

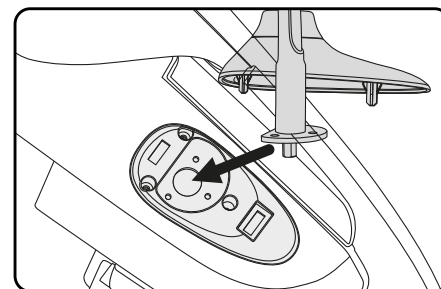

Fig. 1

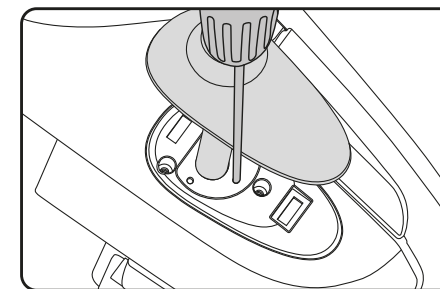

Fig. 2

Set-up and Assembly

- Click the plastic foot of the bracket onto the installation surface of the massage chair. (Figs. 3+4)

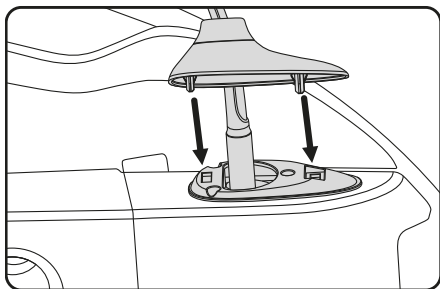

Fig. 3

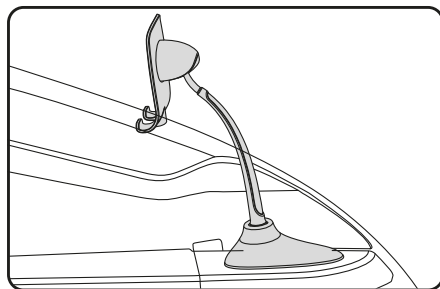
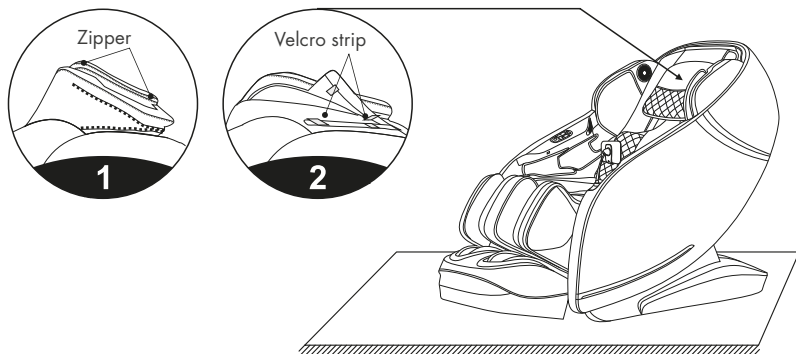

Fig. 4

NOTE: The connection for the remote control is located on the inside of the holding under the seat cushion. Insert the cable and secure it.

4. Using the pillow and backrest cushion

- The kneading intensity of the massage on the neck and shoulder can be alleviated by using the pillow. We recommend using the cushion.
- The backrest cushion is connected to the backrest by a zipper (1), and the pillow is connected to the backrest cushion by a Velcro strip (2).



Set-up and Assembly

5. Floor protection

- To avoid damaging the floor, place the massage chair on a carpet or any other stable surface.

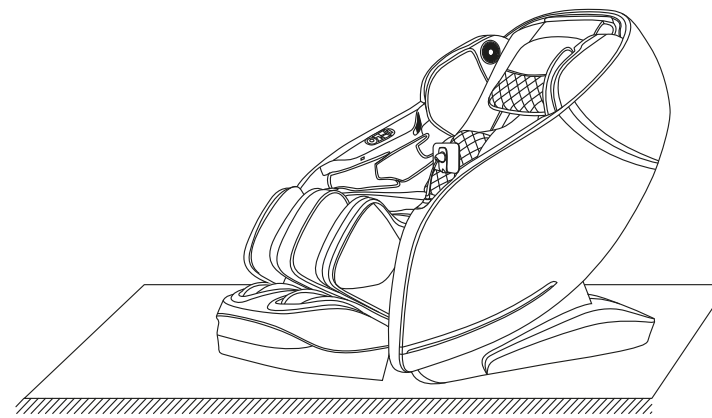

CAUTION: Make sure that you do not move the chair across wooden floors, uneven floors or in confined spaces.

6. Switching off, finishing the massage

- By pressing the power switch (1) during a massage, all massage functions are switched off immediately. The backrest and calf unit are reset, the massage time expires and all massage functions are switched off immediately.
- The power supply throughout the entire massage chair is switched off. (2) (3)

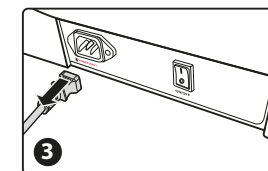
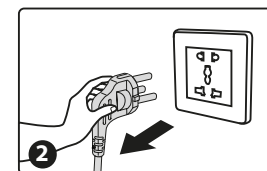
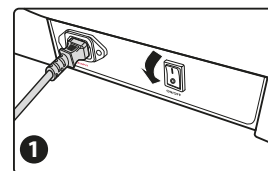

Set-up and Assembly

7. Repositioning the massage chair

- Make sure no cables are lying across the floor. Tilt the backrest somewhat backwards (with the centre of gravity on the wheels). Use your hands to push the chair forwards or backwards, then return it to its original position slowly and gently.

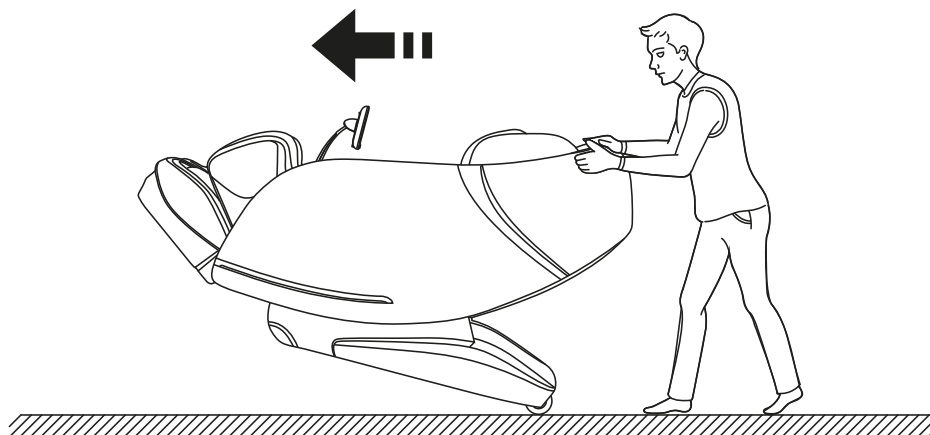

NOTE: Before moving the chair, you must first switch it off and then disconnect the power cord and the connecting cable.

NOTE: Please do not move the chair alone. The second person can lift the chair at the front to position it onto the rollers.

Cleaning | Maintenance | Storage

A | CLEANING THE SYNTHETIC LEATHER

Wipe the synthetic leather with a soft, dry cloth. Please do not clean with products which contain chemicals, such as thinners, benzene and alcohol. Make sure that the cleaning agents do not damage the synthetic leather. Please read the instructions on the cleaning agent very carefully. If the synthetic leather is very dirty, clean it as follows:

1. Moisten a soft cloth with hot water or a commercially-available neutral detergent and wring it out.
2. Check that the cloth has been well wrung out.
3. Clean the surface of the synthetic leather with the cloth.
4. While cleaning, make sure that you rinse the cloth several times.
5. Leave the synthetic leather to dry naturally. Do not use a hairdryer.

- The surface of the synthetic leather may fade or discolour if an unsuitable cleaning agent is used. Before using any cleaning solution on the entire surface, test it first on a small section.
- Cleaning the synthetic leather with alcohol, thinner or petrol-containing agents may lead to discoloration or even remove the paint.

B | CLEANING THE PLASTIC PARTS

1. Put a soft cloth in warm water with a neutral detergent, wring out well and wipe off the plastic parts.
2. Do not use chemicals, such as thinners, benzene and alcohol to clean the plastic parts.
3. Wipe with a microfibre or soft cloth wrung out in clean water.
4. Allow the plastic parts to air dry.

C | STORAGE

- If the device is not used for a longer period of time, the power cable should be wound up and the device should be stored in a dry environment.
- Never store the device at high temperatures or in proximity to open fire. Avoid prolonged exposure to sunlight.
- When cleaning, only use commercially-available products for synthetic leather. Never clean it with thinner, benzene, or alcohol.
- If the device is on an uneven surface, do not roll or push it; lift it up in order to move it.
- Please take breaks after each use and do not use the device a number of times without pauses.

Troubleshooting

FAULTS	EXPLANATION
<ul style="list-style-type: none"> The noise of the engine is audible during use. 	<ul style="list-style-type: none"> This is a normal operating noise.
<ul style="list-style-type: none"> The remote control does not work properly. 	<ul style="list-style-type: none"> Ensure that the mains plug is properly inserted into the socket and that the power switch is switched on. Please check the cable of the remote control.
<ul style="list-style-type: none"> The device stops operating. 	<ul style="list-style-type: none"> The chair switches itself off automatically once the pre-set runtime has been reached or after excessive usage. This ensures the chair has a long operational life.
<ul style="list-style-type: none"> The braintronics® programmes are not starting. 	<ul style="list-style-type: none"> Make sure that you have installed the braintronics app and activated your account. Also check there is a Bluetooth® connection between the smartphone and the massage chair.

Specifications

Dimensions: upright: 80x148x120 cm
 reclined: 80x180x105 cm

Weight: 141 kg

Voltage: 220-240V ~ 50/60Hz

Nominal power: 220 W

Runtime: 20 minutes

braintronics: 21 minutes

Certificates:



EU – Declaration of conformity

Complies with European Regulatory Standards EMC 2014/30/EU and LVD 2014/35/EU.

Warranty conditions

The retailer guarantees a statutory period of warranty for the product described on the reverse. Warranty is valid from the date of purchase. The purchase date must be documented with proof of purchase. The retailer will repair or replace defective products registered within Germany free of charge. This does not include parts subject to wear such as fabric covers. This requires the defect device to be sent in with proof of purchase before expiration of the warranty period.

The warranty is void if a defect occurred e.g. due to outside influences or as a result of a repair or modification not performed by the manufacturer or an authorised dealer. The retailer warranty is limited to product repair or replacement. Under this warranty, the manufacturer or the retailer shall have no further liability and is not responsible for damages due to failure to observe the instructions for use and /or improper use of the product.

If after examining the product, the manufacturer determines the warranty claim is not for a defect covered by the warranty or that the warranty period has expired, the customer is responsible for the costs of the inspection and repair.

Legal notice: None of the contents have any healing value. The diagnosis of and therapy for illnesses and other physical disorders requires treatment by a doctor, alternative practitioner or therapist. The statements are exclusively informative and should not be used as a replacement for medical treatment. Every user is instructed to carefully assess their situation and, where necessary, consult a doctor to determine whether using the product is encouraged in their own unique case. Every use or therapy is undertaken at the user's own risk. We dissociate ourselves from any healing properties or commitments.

Casada International GmbH
 Obermeiers Feld 3
 D – 33104 Paderborn Germany
 info@casada.com
 www.casada.com



Copyright Images and text are subject to the copyright of CASADA International GmbH and may not be used without express consent.
 Copyright © 2019 CASADA International GmbH.
 All rights reserved